

Wireless room occupancy sensor

Automatically detect occupancy in meeting rooms, offices, spaces or zones.

Our wireless motion sensors detect and monitor the presence of people, in real time. The small, battery-powered sensors simply stick to the ceiling, enabling you to detect real-time presence and continually monitor room occupancy.

Features



Passive infrared (PIR) sensor detects motion within 360 degree field of view, up to 6 meters distance. Based on a typical 2.5m ceiling height, approx. 64 degree detection angle resulting in estimated 5m detection



Instant updates when occupancy detected, plus status updates can be configured between 10 minutes and 5 hours



Absence time out can be configured between 2 and 60 minutes



Ultra-low power technology. Battery life typically 5+ years.



Transmit data wirelessly and securely – using AES-128 encryption – via EnOcean wireless protocol, which uses internationally approved, licence-free ISM bands



Integrating sensor data

Our smart gateway receives near real-time data from all sensors within range, converts the raw data into an easy-to-use JSON format, then publishes it using MQTT protocol. Data can be sent - via Ethernet, LTE (4G) or WiFi – to any local or cloud MQTT broker; securely to IBM Watson IoT, Microsoft Azure IoT Hub or AWS IoT Core; directly into Google Sheets; or to a Node-RED application.

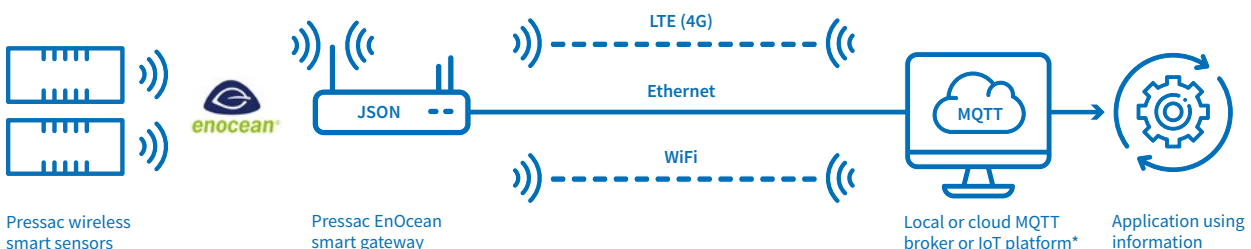

*Ready-made connections with:



Technical specification

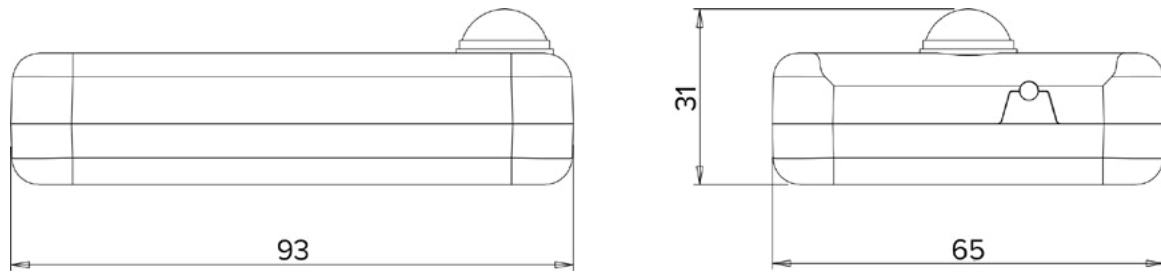

| | |
|-------------------------|--|
| Measurement | <p>Transmission rate: reports presence detection in real time and status updates can be configured between 10 minutes and 5 hours</p> <p>Range: distance up to 6 meters within a 360 degree field of view</p> <p>Absence time out: configurable between 2 and 60 minutes</p> <p>Learn button: configurable ON/OFF</p> <p>LED motion detection indication: configurable ON/OFF</p> |
| Power specification | <p>Power: battery</p> <p>Battery type: AA size 3.6V Lithium</p> <p>Typical battery life: 5+ years</p> |
| Wireless specification | <p>Protocol: EnOcean</p> <p>Radio frequency:</p> <ul style="list-style-type: none"> • 868 MHz for Europe and other countries adopting RED • 902 MHz for USA (FCC specification) and Canada (IC specification) <p>Range: up to 30 metres in buildings and 300 metres in free field</p> <p>Telegram type: 4BS</p> <p>EnOcean Equipment Profile (EEP): A5-07-01</p> <p>Security: 128 AES encryption configurable ON/OFF</p> |
| Enclosure specification | <p>Material: ABS plastic</p> <p>IP rating: IP2X</p> <p>Dimensions: 93 x 65 x 31 mm (approx)</p> |
| Installation | <p>Fixing: adhesive pads or screws provided</p> <p>Operating temperature: 0°C to +40°C</p> <p>Storage temperature: -20°C to +55°C</p> <p>Environment: indoor</p> <p>Calibration: not required</p> |
| Compliance | CE approved, RoHS compliant, FCC compliant |
| Part number | PIR.WAL.BAT.WE.E[868]-[902].[S]-[B] |

